



# On The Square

Sponsored by Heartland Bank

## The Quarterly Newsletter for the McLean County Museum of History

Volume 43, Number 1

March, April, May 2011

### Museum Eyes Revamp of Courthouse Landscaping

With all the efforts that have gone into restoring the exterior of our home, the Old McLean County Courthouse, time has come to address the landscape. The last significant landscaping project on the square was sponsored by the Bloomington Kiwanis Club over 50 years ago. The club planted crabapples which reminded many people of the cherry blossoms which brighten our national capital in the spring.

Bloomington architect and Museum Board member Russel Francois stepped forward and volunteered his services to design a new landscape plan. Russel imagines the Courthouse Square as a great composition, dominated by the grand old Courthouse. He proposes to remove the few remaining crabapples as well as the small, irregularly-placed evergreen shrubs. The proposed landscape improvements include a grassed lawn framed with a continuous mat of evergreen spreading yews planted in a hardwood-mulched bed located adjacent to the public sidewalks. The spreading yews are a soft, very hardy evergreen used extensively in local landscapes. They mature to a height of three feet and a width of five over a ten-year span. The

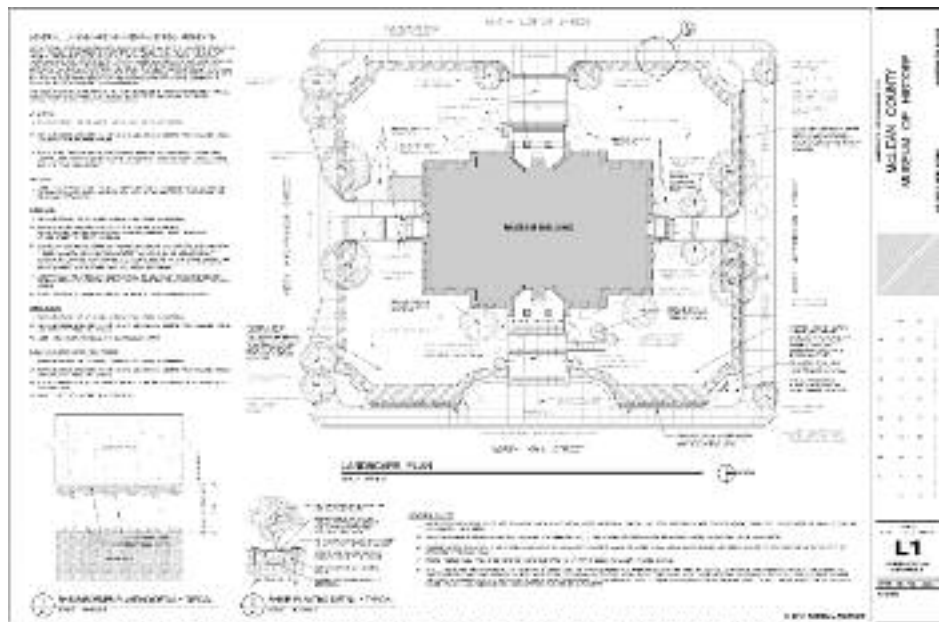

graceful shade trees at the perimeter would, of course, be maintained. Provided at each of the corners are large beds for seasonal planting of appropriate annual flowers.

The McLean County Property Committee voted to approve the plan on February 3. The next step is to raise sufficient funds to carry the project out. Museum Executive Director Greg Koos is organizing a committee to move this project forward. The committee will be tasked with developing a plan to identify sources of support for this project. *(continued on page 5)*

**Inside this issue:**

- Know Your Board Members . . . . . 2
- Tap a Tree With Us . . . . . 3
- Discover Pillsbury's Architectural Gems by Bus . 3
- Tri-Valley History Fair Projects Featured . . . . 4
- Kerber's Perspective on Vietnam War . . . . 4
- Architecture of Spring: A Poetry Reading. . . 5
- New Members . . . . . 5
- Museum's 2011 Spring Interns . . . . . 6-7
- Focus on Volunteers . . . . . 7
- Museum Receives GE Assembly Line Chair . . 8
- New to the Collections . . . . . 8-10
- The New Bloomington Federal S & L . . . 9
- New Items Available in Gift Shop . . . . 10
- "History Reads" Book Club Begins in May . . 11
- Volunteer Help Wanted . . . . . 11
- Stocks and the Presidency . . . . . 12
- Toys and Games We Remember . . . 13
- Wanted: Colonial or Admiral Factory Items . . 13
- State Farm is Museum's Good Neighbor . . 13
- Calendar of Events . . . . . 14-15
- Mystery History Quiz . . . . . 16

# On The Square

## Quarterly Newsletter

Volume 43, Number 1, 2011



Edited by  
Susan Hartzold  
Bill Kemp &  
Bill LaBounty

**McLean County Museum of History**  
200 N. Main St., Bloomington, IL 61701  
Phone (309) 827-0428 Fax (309) 827-0100  
[www.McHistory.org](http://www.McHistory.org)

**HOURS**  
Mon., Wed., Thur., Fri. & Sat. 10 a.m.-5 p.m.  
Tuesday 10 a.m.-9 p.m.

**STAFF**  
Greg Koos, Executive Director  
Susan Hartzold, Curator of Collections and Exhibits  
Mary Anne Schierman, Dir. of Volunteers and Interns  
Bill Kemp, Librarian/Archivist  
Jeff Woodard, Dir. of Marketing & Comm. Affairs  
Candace Summers, Director of Education  
Graham Cowger, Mgr. of Development Operations  
George Perkins, Assistant Librarian/Archivist  
Terri Clemens, Registrar  
Rachael Kramp, Education Program Coordinator  
Harlan Fuller, Bookkeeper  
Betty Turchirollo, Volunteer Assistant

**OFFICERS**  
Robert Watkins, President  
Rob Fazzini, First Vice President  
Russel Francois, Second Vice President  
Carolyn Yockey, Secretary  
John Killian, Treasurer  
Michael G. Matejka, Immediate Past President

**DIRECTORS**

Craig Alexander	Nancy Froehlich
Carl Behr	Mark Gibson
Al Bowman	Sandra Harmon
Roger Bridges	John B. Meek
Brad Briney	Pam Muirhead
Willie Brown	Benjamin Rhodes
David Dorris	Matt Sorensen
Mark Dunn	Bill Wetzel Jr.
Guy Fraker	Richard Wilson

**PAST PRESIDENTS**

David Ashbrook	Steve Wannemacher
Edward B. Jelks	Chuck Wright
Benjamin J. Rhodes	Carol Struck
Don Skaggs	

**DIRECTORS EMERITI**

Barbara Allsup	James A. Stahly
David Ashbrook	Carol Struck
Maryfern Bartrum	Mike Sweeney
Jack Bowles	Steve Wannemacher
Edward B. Jelks	Lloyd Watkins
Davis Merwin	Chuck Wright

## Know Your Board Members

In order to let Museum members know more about the important people who keep the Museum running, the Museum will highlight a members of our Board of Directors. This month's feature is on Board President Bob Watkins.



**Q: How long have you been involved in the Museum?**

I was asked to join the Board by then Board President Chuck Wright in 2001.

**Q: What is your role as Board President?**

I serve as chairperson of both the full Board meetings and the Executive Committee. I work with Executive Director Greg Koos to set the agenda for Board and Executive Committee meetings. In between meetings, I serve as a contact point for Greg and the staff, as issues arise. I assist with fundraising, which is vital for any non-profit organization.

**Q: What are some current challenges facing the Museum?**

The economy has been a big challenge, but we are holding our own thanks to our loyal members. Growing membership, which goes hand in hand with fundraising, is challenging as well. We need to renew the permanent exhibits, which are nearing their twentieth birthday.

**Q: Likewise, what are some opportunities?**

There are huge opportunities for a number of reasons. We live in a community with great financial and intellectual wealth. We have an incredibly energetic and talented staff. We have a great location due to our partnership with McLean County. All of that means we can continue to find new, inno-

vative and exciting ways to tell the county's story to new audiences.

**Q: What is one interesting thing about the Museum that would surprise a lot of people?**

We are one of a tiny number of local history museums that is fully accredited by the American Association of Museums. Having recently gone through the accreditation process, I can attest that it is very rigorous. It was a great tribute to our staff and all volunteers.

**Q: What does local history mean to you?**

People often forget that incredible, world-changing events can happen in places like our community. What if Davis and Fell hadn't convinced Abe that he should pursue the presidency? What if Mecherle hadn't decided to start an "honest insurance company?"

**Q: What is your "day job"?**

I work as a government relations attorney at State Farm.

**Q: Do you have family?**

Yes. I'm married to Charmelle Watkins and we are the parents of Ryan (12), Reid (8) and Mariana (7). (- continued on page 3)

# Tap a Tree with Us!

Join the Museum, in partnership with Sugar Grove Nature Center, for a fun and educational afternoon exploring the traditions and history of maple “siruping” in McLean County. This program will be held at Sugar Grove Nature Center in Funks Grove on Saturday, March 12, from 1:00 p.m. to 4:00 p.m. It is being held in conjunction with the Museum’s current exhibit, *Come & Get It! The Way We Ate, 1830-2008*.

The workshop will begin with a short talk by Mike Funk, who currently owns and operates Funks Grove Pure Maple Sirup. He will share some of the history of his family’s early sirup making traditions after the Funks settled the area in the 1800s, including why they spell it “sirup” and not “syrup!” In addition, participants will experience the Native American method of boiling sap, learn about the biology of the maple tree, sample tasty maple snacks, and actually tap a tree.

Registration has now started and is open to adults ages 18 and older. The fee is \$7 per person. Register by contacting the Education Department via telephone at (309) 827-0428 or via email at [education@mchistory.org](mailto:education@mchistory.org)



Workers unload the syrup buckets at Funks Grove in this 1933 picture. Courtesy *The Pantagraph*

ry.org. Registration forms will also be available at the Museum and at Sugar Grove Nature Center. The registration deadline is Friday, March 4, with a limited capacity of 60 people. Participants must provide their own transportation to and from Sugar Grove Nature Center. Register today!

## Discover Pillsbury’s Architectural Gems by Bus

Join Greg Koos, Museum executive director, for an afternoon exploring Bloomington-Normal in search of homes, business and schools designed by one of McLean County’s most well-known architects, Arthur L. Pillsbury. The Saturday, April 2, tour will start at 1:00 p.m. at the Museum.



The tour will begin in Downtown Bloomington and focus on Pillsbury’s commercial buildings, some of which were constructed after the Great Fire of 1900. Next up will be a ride through residential neighborhoods. The tour will include an inside look at the boyhood home of Adlai E. Stevenson II, located at 1316 E. Washington St. Topics to be discussed during the tour will include architectural styles and building technologies during Pillsbury’s lifetime. Stories will also be told about the people who owned Pillsbury designed buildings.

The registration fee is \$20 for members and \$25 for non-mem-

bers. Registration will begin on March 7 and seating is limited to 28 people. All registrations are on a first-come, first-serve basis, so register early! Watch your mailboxes for a registration mailer coming soon, or pick up a form at the Museum.

This program is being held in conjunction with the Museum’s current exhibit *A Passion for Detail: The Architecture of A.L. Pillsbury*. For more information, please contact the Education Department via email at [education@mchistory.org](mailto:education@mchistory.org) or by phone at (309) 827-0428.

(Board Members, continued from page 2)

**Q: What do you like to do to relax?**

I like to read, and I enjoy traveling with my family.

**Q: Why do you give time and money to the Museum?**

No organization does a better job at fulfilling its vital mission with such passion and excellence. Everyone’s time, money and effort makes a huge difference. Each dime and every minute gets put to good use.

# Tri-Valley History Fair Projects Featured

Brace yourself for another astounding round of Tri-Valley Middle School History Fair projects, which will be displayed at the Museum from April 6 through April 26. In late March, students from Mr. Robin Roberts' seventh grade social studies classes will be participating in the Illinois History Expo 2011 at Eastern Illinois University in Charleston. Following the regional competition, the top-ranked Tri-Valley projects will be displayed at the Museum. Past project topics have included *The Pantagraph*, Miller Park Zoo, Beich's, BroMenn Hospital, Laesch Dairy, the Kickapoo, Route 66 and many more.

This annual statewide competition will give junior high and high school students from around the state the opportunity to display their knowledge on Illinois history. Projects are judged in two age groups, sixth

through eighth grades, and ninth through twelfth grades. Tri-Valley projects that receive a "superior" rating at the regional competition will advance to the statewide Illinois History Expo in Springfield. From this competition, the top two projects from each age group will then represent the state at the National History Day competition at the University of Maryland.

For the fourth year in a row, Museum staff will be judging projects and picking winners in the following categories: Best Historical / Critical Thinking project; Most Creative; Best McLean County Themed project; and Best Overall. Winners will be presented with an award certificate at the May meeting of the Museum Board.

## Kerber to Provide Veteran's Perspective on Vietnam War

Join the Museum for an evening exploring the Vietnam War through the eyes of local veteran Mike Kerber. In his program, *Lessons Un-Learned*, Kerber will explore some of the history of Vietnam, the political climate in the U.S. leading up to the war, how tensions over the war ultimately divided the U.S., and share some of his personal experiences and feelings regarding the war. This program will be held in conjunction with the Museum's current exhibit *A Turbulent Time: Perspectives of the Vietnam War*. This program is free and open to the public and will be held in the Governor Fifer Courtroom at the Museum on Tuesday, April 12, at 7:00 p.m.

Kerber served an eight-month tour of duty during the Vietnam War, from 1969 to 1970. He was drafted into the Army after graduating



Mike Kerber poses with some of the equipment used by his unit during the Vietnam War.

from Southern Illinois University in 1968. After training in the artillery, he served in Vietnam with the 101st Airborne Division in the very northern part of South Vietnam. His unit was assigned to the Ashau Valley where they were tasked with preventing infiltration by the Viet Cong. His program will include pictures of the Ashau Valley, of the artillery firebases he served at, and also photographs of what "life in the mud" was like at those firebases.

After the war, Kerber was involved in grain trading throughout the Midwest, and for the last 23 years of his career he was a commodities trader. He is very active in several organizations in Bloomington-Normal, and also speaks at area high schools about his experiences during the war.

For more information about this program, contact the Education Department at (309) 827-0428 or via email at:

[education@mchistory.org](mailto:education@mchistory.org)

## The Architecture of Spring: A Poetry Reading

Join the Museum in welcoming back the Poetry at Babbitt's Workshop for a reading inspired this time by the current exhibit *A Passion for Detail: The Architectural Legacy of A. L. Pillsbury*. Led by local poet Kathleen Kirk, this program will be held on Tuesday, March 29, at 7:30 p.m. It will be free and open to the public and held in the Museum's Governor Fifer Courtroom.

Local authors will read poems about architecture and the eternal contrast between structures man-made and those from nature. Poets, too, have a passion for detail! Below is a preview of one of the poems which will be read during this upcoming program, written by the Museum's very own volunteer, Peg Kirk.

### *Arthur Pillsbury, Architect*

*He wasn't Wright, but he wasn't wrong. Frank designed homes his way.*

*Arthur drew what his customers wanted while he invented the perfect angle,*

*the right arch, the well-placed lattice  
— a subtlety of refined details*

*— to confirm that an artist's touch  
can rest comfortably in any home.*  
—Peg Kirk

For more information about this program, contact the Museum's Education Department at (309) 827-0428 or visit the Museum's website at <http://www.mchistory.org>.

## Martin A Wyckoff Endows Preservation Fund

Martin A. Wyckoff, who served as curator of Collections from 1980 to 1993, died this past November. More than 100 of his friends and acquaintances gathered at the Museum on January 20, for a celebration of his life. They enjoyed musical selections from the 33rd Illinois Volunteer Regiment Band, a wide range of songs from Mark Boon and reminiscences about Martin. Among the sing-alongs performed were George M. Cohan's *Over There* and Roy and Dale Roger's *Happy Trails*. All there agreed that it was a unique send off for a unique person.

Greg Koos, the Museum's executive director, announced that by Martin's direction, the Museum will be creating the Martin A. Wyckoff Historic Preservation Fund. This permanent fund, which Martin has endowed by a significant gift of property, will be used for the restoration of Museum collections. His presence and influence will last for generations to come. Gifts made in Martin's memory will be added to that fund.

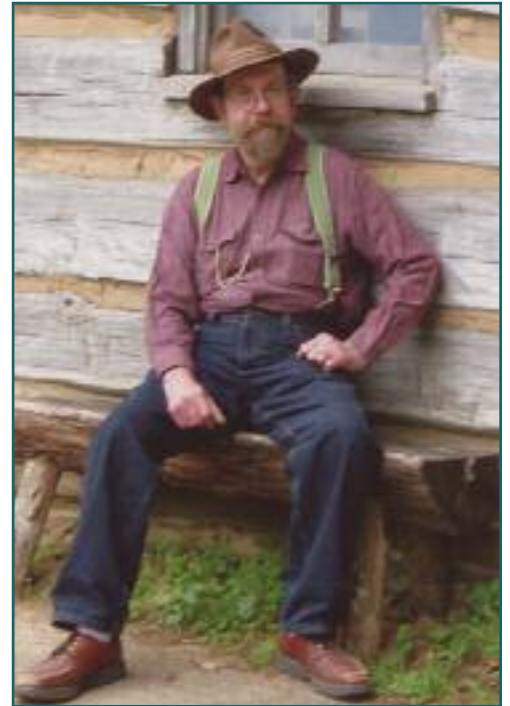

Martin Wyckoff

## The Museum Welcomes the Following New Members

Thanks so much to the newest  
members of the Museum!

Brian and Consuelo Cunningham  
Dr. Janet Krejci  
Drake and Jan Elfine Zimmerman  
George and Jackie Bottrell  
Jackie Clement  
Mr. and Mrs. Frederick Kent Thieman  
Mr. and Mrs. Larry Starkey  
Mr. and Mrs. Samuel A. Perroni  
Mr. and Mrs. Scott King  
Mr. Bill Goold  
Mr. Don Yager  
Ms. Amy Johnson Davis  
Penny and Rick Boser

*(Landscaping - continued from page 1)*

To date, Illinois State University Trustee Betty Kinser, local artist and gardener Mike McNeil, Director of Illinois State University Horticultural Center Jessica Chambers and Museum Board member and gardener John Killian have agreed to serve on the committee. Others who are willing to make a commitment are welcome to join with us. Call Greg at (309) 827-0428, for more information.

# Museum's Spring 2011 Interns



**Amanda Packman** is a senior elementary education major at Illinois Wesleyan University. This semester she is serving as the public service intern working under Rachael Kramp and Candace Summers. She is very excited to be with school groups, Girl Scout badge workshops, outreach programs and the Trailblazers membership program — shadowing and planning programs, and eventually leading programs. She hopes to use her knowledge of education and planning skills to gain a better understanding of how a museum brings programming, specifically educational programming, to the public.

**Andrew Border** is a graduate student at Illinois State University studying archaeology. His academic interests are historical North America, and he is currently starting work on his thesis. Before going to ISU, he graduated from Loras College in Dubuque, Iowa. In addition to graduate work, Andrew enjoys playing saxophone, going to cultural events and playing a few hands of poker. Andrew is working in the Library / Archives, where he is creating a detailed inventory of the

William Wantling Collection, which includes correspondence, published and unpublished writings, college research papers and much more. Andrew will also write a biographical sketch to accompany the finished inventory (called a finding aid). William Wantling



(1933–1974) was a U.S. Marine, poet, and college instructor. He was born in East Peoria, and in 1966, enrolled at Illinois State University, where he completed both bachelor's and master's degrees. Wantling's work still attracts attention, and in recent years Tangerine Press in England has published two collections of his poetry.

**Sam King** is working in Collections as an intern. Sam is a second year graduate student at Illinois State University, studying bioarchaeology. He comes to us from Pasco, Washington. His bachelor's degree is from Washington State University in Pullman. Sam is also doing a graduate assistantship at the Illinois State Museum. Working with Museum Registrar Terri Clemens, Sam is learning to use PastPerfect museum software as



he inventories and updates records in art storage. He will also be processing the archeological objects that have not yet been reevaluated, along with large agricultural and household objects. Sam is going to use his bioarcheological knowledge and research to advise the Museum on how to repatriate our Egyptian mummy head, which has been removed from the collection.



**Lexi Baldacci** is an intern in the Education Department. She is a senior at Illinois State University majoring in history and English with a minor in Spanish. Lexi is working on the World War II loan kit, which is to be used by local

teachers as a supplement in teaching about the war. Lexi hopes that the kit will bring history to life, and that studying local contributions to national and international events will help students to form an intimate connection with history. She is looking forward to working at the museum, learning a lot, and applying the skills that she has learned at ISU in a professional setting.

**Jacqueline Arroyo** is between schools, having completed an associates degree at Heartland Community College and waiting to start at ISU this coming fall, where she will begin work on a degree in

fashion design. She's keeping busy between schools by learning more museum work, the field she believes she would like to enter after she graduates. She is working with staff Curator Susan Hartzold to update condition reports of textiles in the collection. As part of her internship she is also learning some photography skills and taking digital photos of textiles for the database. When asked what she thought of the internship so far Jacqueline responded, "I'm really excited about working with the historic costumes —learning more about different types of fibers and

fabrics and how clothing was constructed in the past."



## Focus on Volunteers

Twice a week, **Shirley Clemens** quietly comes into the Museum's main office and performs a valuable service — volunteering as our bookkeeper. Having contributed 625 hours to date, Shirley says she loves what she does and wishes she could do more. She really likes the challenge of in-depth projects. Recently, she took on the job of organizing the financial records for the Adlai Stevenson house on East Washington Street. The records dated back to 1996 and needed to be categorized and reviewed prior to the sale of the property. Shirley enjoyed going through the boxes and boxes of materials and methodically sorting, listing and filing all of the important papers. When she was in school, she loved anything with numbers. She majored in math at Illinois Wesleyan University where she met her husband Don. They recently celebrated their sixtieth wedding anniversary.

Beside her volunteer work, Shirley always does all four types of puzzles in *The Pantagraph*. Making things fit and putting them in order, brings her great joy. She loves to do yard work, needlework, read, and travel. Eight years ago, she and Don moved into Bloomington from Lexington and restored a house. During this process, Shirley refinished the wood floors, tiled the kitchen and bath, and landscaped the yard, including laying a brick sidewalk. Clearly, she is a woman of many talents and always enjoys a challenge!

Shirley grew up in the small town of Mazon, Illinois, between Dwight and Morris. Growing up on a farm, she became interested in horses and ended up showing them most of her life. She even participated in an international horse show in Chicago. While raising four children, she did the bookkeeping at her husband's insurance agency on an as-needed basis. Owning an antique store in Lexington with husband Don and daughter Terri, gave her more bookkeeping experience. When her daughter, staff member Terri Clemens, saw the need for the Museum to have a bookkeeper, she recruited her mom to be a volunteer.

The staff and other volunteers all enjoy working with her and are thrilled to have her on the team.



# New to the Collections

## OBJECTS

- ❑ Nikon video camera; donated by Doug and Dianne DeLong
- ❑ Dresser mirror, Happy Hour spice tin, PTA pin, 2 hooked rugs and a wall hanging made by Molly Brewer Rasor, 1940s BHS letter sweater of Norman or George Johnston, Alice Rasor Johnston's American Legion and Red Cross pins, carbon paper; donated by Mary Green
- ❑ Osco tags and bags; donated by Ward Waller
- ❑ Army Air Corps uniform and coat of Billie Israel; donated by Dorothy Israel
- ❑ Peggy Powell Sours' wedding dress and veil; donated by Peggy Sours
- ❑ Bloomington Trunk Co. trunk of Viola Detloff; donated by

Karen Downen

- ❑ Meyer Brewing tumblers; donated by Carol Camp
- ❑ Laptop computer, RS Prussia tankard, lamb cookie jar; donated by Greg and Carol Koos
- ❑ Chair from GE assembly line; donated by GE
- ❑ Bloomington Raiders jacket with mascot logo; donated by Doug and Kathy Clemens
- ❑ Portraits of Kathryn and Ruth Crane by Bob Popelka; donated by Kathryn Crane Reilly
- ❑ Pat and Nina Chesebro's Christmas stockings, Nina's ISNU gym bloomers; donated by estate of Nina Chesebro
- ❑ Happy Hour box, Bloomington flag, Three-I League die for making token; donated by David A. Hall

## ARCHIVES

- ❑ Various, including Bloomington-Normal Public Transit System schedule; paint chart from West Side Coal and Lumber Co.; booklet from Bloomington Federal Savings & Loan; Ainsworth Pure Ice Co. coupon booklets; and much more; by Margaret Bienemann
- ❑ Wall-size railroad map of Illinois, 1960; by E. William Rolley
- ❑ Various, including 1935 Illinois-Indiana-Iowa League (minor league baseball) schedule; First English Lutheran Church (Bloomington) booklet, 1942; St. John's Lutheran Church (Bloomington) material, 1960s and 1970s; and other items; by Mary Green
- ❑ Items relating to White Place, including four issues of White Place neighborhood newsletter, and other material; by Judy Stone
- ❑ Large collection of material relating to WIHN radio station, including balance sheets, newspaper clippings, correspondence, FCC applications, floor plans, maps, meeting notices and minutes; by Dave S. Wolfenden
- ❑ Several items, including certificates, relating to World War II Women's Army Corps service of Dorothy Mary Washburn; by Barbara Washburn
- ❑ Mitzi (high school sorority) scrapbook, 1932-1939, given to Myra Shepard by Jane Wettaw; by Suzie Zeigler, M&J Sales
- ❑ Nine-page manuscript by

## Museum Receives General Electric Assembly Line Chair



The Museum recently received a donation of a chair used by a General Electric assembly line worker in its Bloomington factory. The plant closed last December, ending 55 years of local production. The plant began operations in 1955, making electrical control equipment for commercial and industrial uses. It employed more than 1,000 workers at the time. Though slow to employ African American workers, it was one of the first to do so. The donation also included documents relating to items produced in the factory.

This metal and laminate swivel chair was used by workers on the assembly line at the GE plant. It was meant to swivel or could be made stationary. It was made by the Toledo Metal Furniture Company. The frame is metal and the seat and back are formed plastic.

Barbara Findley Stuart, "My History with the Normal Public Library" (2010); by Barbara Findley Stuart

- ❑ Wide-ranging collection of material relating to the General Electric plant (Bloomington), including product catalogs; newspaper articles, employee newsletters and other items; by Gretchen Quistgaard
- ❑ Blueprints for Norfolk & Southern Diamond-Star siding, 1988, 10 sheets; by Rogers and Barbara Cavitt
- ❑ Material relating to the architectural practice of Arthur L. Pillsbury, including perspectives and / or plans of various buildings, including the Illinois Wesleyan University gymnasium, Jackson County (Illinois) Courthouse; and others; by Richard Mills
- ❑ Stern's furniture store poster / flier, 1955; blank Corn Belt Bank checks; by Sybil Mervis

#### BOOKS

- ❑ Illinois State University master's thesis by Carl J. Zachmann, "A Study of Consumer Choice and Loyalty through the Remedies, Medicines, and Nostrums from Two Midwest Site Assemblages" (2010); by Carl J. Zachmann
- ❑ Illinois Wesleyan University and Bloomington High School yearbooks, various years; St. John's Lutheran cookbook, 1997; by Mary Green
- ❑ *History of the Twin City Amateur Astronomers 1960-2010* by Carl J. Wenning, (published in 2010); by Carl J. Wenning
- ❑ *Legacies of Courage and Faith* (2010), containing more than twenty profiles submitted by

### The "New" Bloomington Federal Savings & Loan

This brochure dates to late 1957 when Bloomington Federal S&L celebrated the opening of its modern new home at the southwest corner of East and Washington streets in downtown Bloomington. Today, this building is known as the Government Center and houses offices of the County of McLean and the City of Bloomington.



The Bloomington Federal building was the work of the local architectural firm Lundeen and Hilfinger and the firm's visionary designer Richard Williams, an architecture professor at the University of Illinois. This building represented a revolution in bank architecture, as fortress-like brick and stone gave way to the airiness of glass panels bracketed with metal trim. "The simplicity of modern design and the latest architectural developments have combined to achieve beauty and efficiency," the brochure reads in part. "Color and lighting have been skillfully blended to give an atmosphere of graciousness."

This and many other interesting items came to the Museum by way of two large donations from the home of Arthur E. Bienemann, who for years ran a Twin Cities coal delivery company. Bienemann's daughter Margaret made the donations.

The Museum is always interested in brochures, fliers, posters, general advertisements, stationery and the like from local businesses. If you have something along these lines, please give Museum Librarian / Archivist Bill Kemp a call at (309) 827-0428.

members of the General Joseph Bartholomew Chapter of the Sons of the American Revolution; by Dave Ashbrook

- ❑ Large collection of local poetry / literary publications, mostly

1960s and 1970s, including *Daddy Never Bought Me a Horse* (undated) by the Crazy Alice Poetry Collective; *The Awakening* (1969) by William Wantling; issues of the

*McLean County Poetry Review* (1975-1977); and many others; by Greg Koos

- ❑ McLean County plat book, 1914; by Lee Rudolph
- ❑ History of the Pendleton District, South Carolina (1913); by Nancy J. Miller

#### PHOTOS

- ❑ Various, including local buildings, such as the Bloomington Club and Scottish Rite Temple

(Consistory); group photos of Funk Bros. Seed Co. and People's Bank, among others; by Mary Green

- ❑ Tennis club, posing at the northwest corner of Jefferson and Madison streets (Bloomington), ca. 1889; by Dr. William Fleming
- ❑ Large number of photographs relating to General Electric plant, including shop floor

scenes and employees; by Gretchen Quistgaard

- ❑ Five railroad photographs, various scenes, Illinois Central; one of the Chicago & Alton; by Roger and Barbara Cavitt
- ❑ Two black-and-white 4x5 photos of Adlai E. Stevenson campaign stop at Bloomington GM&O passenger station, either 1952 or 1956; by Sybil Mervis

To make donations of photographs, books or archival materials call the Museum's Librarian/Archivist, Bill Kemp. If you have objects you wish to donate to the collection call the Museum's Curator of Collections, Susan Hartzold. Both can be reached at the McLean County Museum of History, 827-0428.

## New Items Available In Gift Shop

We are happy to announce new items available for purchase in the Museum's On the Square gift shop. In conjunction with our current exhibit *A Passion for Detail: The Architecture of A.L. Pillsbury*, we are offering the new book by Rosemary Thornton, *Sears Homes of Illinois*. From 1908 to 1940, Sears, Roebuck, and Co. sold nearly 75,000 homes through its mail order Modern Homes program. Families across the nation purchased these "kits" and built their very own homes. This book, which is lavishly illustrated, can help many Illinoisans figure out if they are living in a Sears Home or what type of Sears Home they are living in. Purchase your own copy for \$26.99.

Are you a baseball nut or do you have an interest in the history of baseball in Central Illinois? Then look no further. The Museum is proud to offer the newest book about local baseball legend Charles "Old Hoss" Radbourn. The book, *Fifty-Nine in '84: Old Hoss Radbourn, Barehanded Baseball, and the Greatest Season a Pitcher Ever Had* by Ed Achorn, offers an in-depth look into the history of baseball when it was still in its infancy. Pick up your copy today for \$25.99.

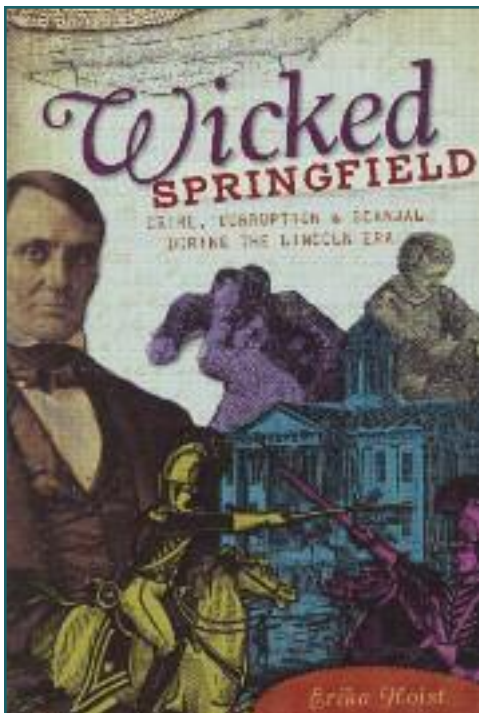

Do you have an interest in crime, corruption, scandal and ... Abraham Lincoln? Then pick up a copy of the book *Wicked Springfield: Crime, Corruption, and Scandal during the Lincoln Era* by Erika Holst. This book examines the capital city's sordid past during Lincoln's 24-year residency in Springfield. From cases of slander and defamation, to near duels and scandalous divorces, murder, and other depravities, it is all here. Purchase a copy of this interesting book for \$15.00.

Finally, in conjunction with our current exhibit *Come and Get It!: The Way We Ate 1830-2008*, we are offering the new book by Terra Brockman, *The Seasons on Henry's Farm: A Year of Food and Life on a Sustainable Farm*. Covering a year on her family's Central Illinois farm, biologist and writer Brockman takes readers through the cycle of farming from seeding to harvest and all of the toils in between. Brockman also offers recipes incorporating the crops of her family's farm throughout the book as well. Pick up a soft cover version of this book for \$17.00.

*Wicked Springfield* is one of four new books now available in the Museum's gift shop.

Also, an additional 20 percent discount on all clearance items for sale in the gift shop continues as well. Stop by the gift shop today and pick up some of these titles and more today!

# “History Reads” Book Club Begins in May

Do you love history? Do you love to read? The Museum and Bloomington Public Library have teamed up to create a new history book club called “History Reads.” This club, which meets at the Museum, will focus on reading books that deal with Illinois history and may include fiction, nonfiction, biography or local history. This program is free and open to the public.

The club meets quarterly on the first Tuesday of the month—May, August and November. The discussion begins at 7:00 p.m. and lasts approximately one hour. This program is held in the Museum’s Governor Fifer Courtroom, and participants are welcome to explore the Museum before or after each meeting. Free parking is available at the Lincoln Parking Deck on Front St. located two blocks south of the Museum.

Meeting dates and selected books:

May 3: *Fifty-Nine in '84: Old Hoss Radbourn, Barehanded Baseball, and the Greatest Season a Pitcher Ever Had*, by Edward Achorn

August 2: *The Seasons on Henry’s Farm: A Year of Food and Life on an Organic Farm*, by Terra Brockman

November 1: *Cahokia Mounds*, by William Iseminger

Copies of each book will be available for checkout at Bloomington Public Library. They can also be obtained via interlibrary loan, or purchased at the Museum’s On The Square gift shop at a discounted price.

For more information on this program, please contact the Education Department at the Museum via email at [education@mchistory.org](mailto:education@mchistory.org) or contact Karen Moen at the Bloomington Public Library at [reference@bloomingtonlibrary.org](mailto:reference@bloomingtonlibrary.org).

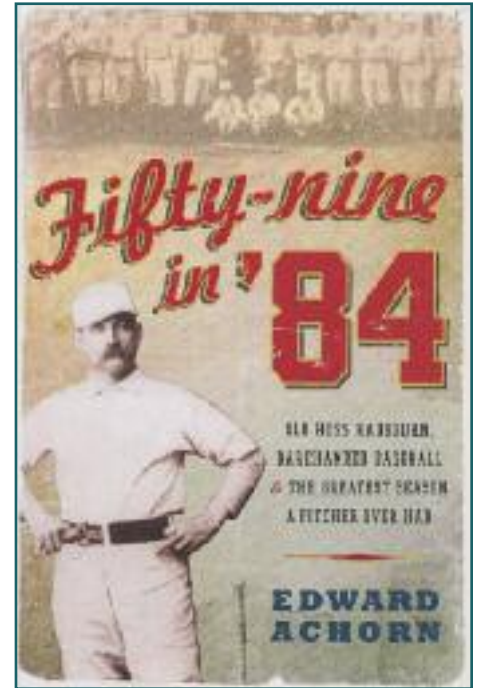

*Fifty-nine in '84* tells the story of Charles “Hoss” Radbourn and the early history of baseball. The May “History Reads” featured book is now available in the Museum’s gift shop.

## Volunteer Help Wanted

**Girl Scout Badge Program Volunteer** – In this position, the volunteers assist Museum educators in providing quality Girl Scout history related badge programs for first through sixth graders. Programs are taught after school and on Saturdays. Each program lasts approximately three hours. A complete training is provided by Museum educators. These programs are craft-related and a lot of fun!

**Reception Desk Volunteers** – Weekend shifts needed. In this position, the volunteer is the official greeter and Museum representative. The reception desk assistant greets visitors, and gives them a brief introduction to the Museum. They also answer the phone, take messages for staff, and answer general questions. A complete training is provided. In this interesting position, you meet visitors from all over the world. Reception desk assistants are asked to serve two four-hour shifts per month. The Director of

Volunteers and Interns works with your schedule and availability.

**Education Outreach Volunteers** – These volunteers are trained to assist the Director of Education and the Education Program Coordinator with school tours. This is a very flexible volunteer opportunity. You are called to assist as the need arises. The average time commitment is usually two hours. Education volunteers work with children of all ages, but primarily preschool through junior high. A complete training and all materials are provided.

Are you interested in meeting people in an exciting atmosphere and contributing to your community? If so, please contact Mary Anne Schierman, Director of Volunteers and Interns, (309) 827-0428 or email: [volunteers@mchistory.org](mailto:volunteers@mchistory.org).



# Stocks and the Presidency

Investors with a sense of the history of the financial markets have high hopes for 2011. That's because since the 1930s the stock market has generally done best in the third year of a President's term. MarketWatch's Mark Hulbert, looking at the Dow Jones Industrial Average since 1896, has found that the average Dow return in the third year was 15.5%. In contrast, the first year of a President's term averaged 8.8%, the second 0.4% and the fourth 4.1%.

Writing in *The New York Times* about the 65 years since World War II, Floyd Norris observed that third years have had positive returns 94% of the time, with an inflation-adjusted median change in the S&P 500 of 18.0%. That's nearly three times better than the median for the fourth year of 6.7%. The fourth year, in contrast, has been best for growth in the Gross Domestic Product, with above-average growth 75% of the time. Indeed, during this time frame, 62% of all economic growth has happened in the third and fourth years of Presidential terms, just 38% in the first two years.

Unlike the "Super Bowl indicator," the third-year phenomenon is statistically significant, though no one has a satisfactory explanation for it.

One popular theory is that Presidents do all they can to have a high-growth economy as they head into re-elections. The table below would seem to bear that out. The table shows total returns for the large companies represented by the S&P 500-stock index.

## Develop your own plan

### Post-war stock market performance in the third year of a presidential term

President	Year	Total return, S&P 500
Harry Truman	1947	5.71%
	1951	24.02%
Dwight Eisenhower	1955	31.56%
	1959	11.96%
John Kennedy	1963	22.80%
Lyndon Johnson	1967	23.98%
Richard Nixon	1971	14.31%
Richard Nixon/ Gerald Ford	1975	37.20%
Jimmy Carter	1979	18.44%
Ronald Reagan	1983	22.51%
	1987	5.23%
George H. W. Bush	1991	30.55%
Bill Clinton	1995	37.43%
	1999	21.04%
George W. Bush	2003	28.70%
	2007	5.49%
Barack Obama	2011	?

Of course, the real driver of stock market returns is the economy, but growth can be affected by politics. Congress headed off major tax increases set to go into effect January 1. This action, coupled with the "Quantitative Easing" policies of the Federal Reserve Board, may lay a foundation for solid growth this year. However, there is some concern that the ills of the housing market have not been fully resolved as yet. Lingering problems in foreclosures and unemployment could undermine the recovery.

If investing were easy, everyone would be good at it. The record suggests that such is not the case. If you would like an independent review of

your portfolio management strategies, we will be pleased to be of service.

If you are considering a change of advisors, please put us on your short list. We will be pleased to meet with you and present our qualifications. Give us a call today.

© 2011 M.A. Co. All rights reserved.



### MAIN OFFICE:

205 N. Main Street, Suite 101  
 Bloomington, IL 61701  
 309-662-4444 / 888-897-2276 toll free  
[heartlandtrust@hbtbank.com](mailto:heartlandtrust@hbtbank.com)  
[www.hbtbank.com](http://www.hbtbank.com)

# The Toys and Games We Remember



The Education Department is looking for some help to create a new educational program for our Senior Reminiscences Program. Based on feedback from residents of local senior centers and nursing homes, we will be creating a new toy program to add to our current offerings. This program, which we are tentatively calling “Play It Again: The Toys and Games We Remember,” will feature toys and games from different time periods. We are looking for ideas and suggestions about what kinds of toys and games to include in this program. We want to include things from the 1930s through the 1960s, mainly those that were representative of the time. Toys for this program will need to be easy to handle or pass

around a group, not contain a lot of pieces, and not be too big in size or weigh too much. If anyone has any ideas about toys and games for us to include, especially if you remember what you played with as a child, please contact Candace or Rachael in the Education Department via email at [education@mchistory.org](mailto:education@mchistory.org), or by telephone at (309) 827-0428. We look forward to hearing your ideas!

## WANTED: Items from Bloomington’s Colonial or Admiral Factories

The Colonial Radio Corp. opened a modern plant at 903 Morrissey Drive in Bloomington shortly after World War II, manufacturing radios and radio-phonographs, mostly for Sears Roebuck stores. Sylvania Radio then bought out Colonial and the plant was then sold to General Mills. The company briefly made home appliances and kitchenware from the plant, before selling it to Admiral, which began production of radios and televisions from the same facility in 1949. Peak employment at Admiral was 1,200, with 2,500 televisions churned out on a typical day. The plant ceased production in 1957, re-opened in 1960 as a parts warehouse, and then closed for good in 1987. Wildwood Industries last occupied this plant.

The Museum is looking for donations of items manufactured by Colonial Radio and Admiral in the Bloomington plant, especially a radio or television, as

well as photographs, product catalogs or anything else that relates to the local history of these two factories.

If you are interested in making a donation, please call Curator Susan Hartzold or Librarian / Archivist Bill Kemp at (309) 827-0428.

## State Farm is Museum’s Good Neighbor

The Museum received \$6,500 from the State Farm Companies Foundation’s Good Neighbor Grant Program, as a result of the contributions of our State Farm volunteers. Thirteen employees and retirees gave forty or more hours of their time and talents to this organization in calendar year 2010. We thank the following volunteers for choosing the Museum as the beneficiary of these funds: Deborah Boston, Shirley Boward, Michael DeVore, Wilma J. Farmer, Mary Diane Hawk, Karen Heinrich, Charles Lamlein, Judith Myers, Margaret D. Myers, Robert J. Scott, Sharon L. Tallon, Mary Alice Wills and Patrick Wilson.

The financial support we receive through this program contributes to the development of new educational programs for children and adults. We applaud State Farm and its employees for placing great value on volunteer service and this community.



Colonial Radio produced console radio/phonographs like this Silerverton, sold by Sears Roebuck.

# McLean County Museum of History

## Calendar of Events for March, April, May 2011

Through August 6

**A Turbulent Time: Perspectives of the Vietnam War** explores the complex ways McLean County residents perceived and responded to this crucial 20th century event.



Saturdays until August 6

**Support our Veterans.** Every Saturday during the Vietnam exhibit, visitors may donate items listed below in exchange for the admission fee. These items will be given to patients and residents of the Department of Veterans Affairs Danville Medical Center. New and unused items: (no hotel items please) spray deodorant, mouthwash, hairbrushes, combs, hand liquid soap, body powder, toothpaste, toothbrushes, shaving cream, pre-shave lotion, after-shave, disposable razors, stationery kits, paperback puzzle books (large print is preferred), playing cards, t-shirts, and socks.

Through January 28, 2012

**Come and Get It! The Way We Ate 1830-2008.** This exhibit explores the eating habits, cooking equipment and methods and diverse food traditions of McLean County residents since the early 1800s.



Through August 30

**A Passion For Detail: The Architectural Legacy of A.L. Pillsbury.** This exhibit showcases the productive career of an early 20th century Bloomington architect.

Second Thursday of every month until May

**Lunch and Learn at the Museum.** Bring your brown bag lunch to the Museum's new series, featuring engaging and enlightening topics for discussion. Join us the second Thursday of every month from now until May for a new topic to explore and discuss. The programs will be held in the Museum's Governor Fifer Courtroom from 12:10 to 12:40 p.m. The next three Lunch and Learns will be March 10, April 14, and May 12. March's Lunch and Learn will feature April Schultz, who will present a program on Irish immigration. Watch your mailbox and email inbox for updates for these upcoming programs. These programs are free and open to the public and sponsored by Illinois Wesleyan University, the McLean County Museum of History and the Collaborative Solutions Institute.

Saturday, March 12

1:00 p.m. to 4:00 p.m.



### Maple Sirup Traditions in McLean County

Join the McLean County Museum of History, in partnership with Sugar Grove Nature Center, for a fun and educational afternoon exploring the traditions and history of maple siruping in McLean County. This program will be held in conjunction with the Museum's current exhibit, *Come & Get It! The Way We Ate, 1830-2008*. Look for more information about how to register on page 3 of this newsletter!

Tuesday, March 29 7:30 p.m. to 8:30 p.m.

**The Architecture of Spring: A Poetry Reading**

Join the Museum in welcoming back the Poetry at Babbitt's Workshop, led by Kathleen Kirk, for a poetry reading inspired this time by the current exhibit *A Passion for Detail: The Architectural Legacy of A. L. Pillsbury*. This program will be free and open to the public and held in the Museum's Governor Fifer Courtroom. For more information, contact the Museum's Education Department at (309) 827-0428 or visit the Museum's website at <http://www.mchistory.org>.

Saturday, April 2 1:00 p.m. to 2:30 p.m.



**Discovering Pillsbury's Architectural Legacy in Bloomington-Normal**

Join Greg Koos, executive director of the Museum, for an afternoon exploring Bloomington-Normal in search of homes, business and schools designed by one of McLean County's most well known architects, Arthur L. Pillsbury. For more information about this program, please see page 3. Watch your mailbox for registration information!

On display from Wednesday, April 6 to Tuesday, April 26

For the thirteenth year in a row, the Museum is honored to host the **Tri-Valley Middle School History Fair Projects**, which will be on display throughout the Museum. These projects were created by seventh grade students, and feature McLean County and Illinois history-related topics.

Tuesday, April 12 7:00 p.m. to 8:00 p.m.

**Lessons Un-Learned: A Veteran's Perspective on the Vietnam War**

Join the Museum for an evening exploring the Vietnam War through the eyes of local veteran Mike Kerber. This program will be held in conjunction with the Museum's current exhibit *A Turbulent Time: Perspectives of the Vietnam War* and is free and open to the public. For more information about this program, see page 4 of this newsletter.

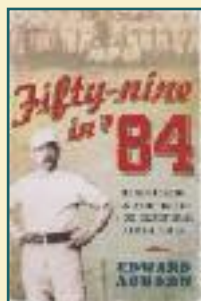

Tuesday, May 3 7:00 p.m. to 8:00 p.m.

**History Reads Book Club**

Join the Museum, in partnership with Bloomington Public Library, for the second installment of the History Reads club. The club meets quarterly the first Tuesday of the month—May, August and November. The discussion will be held at the Museum's Governor Fifer Courtroom at 7:00 p.m. Participants are welcome to explore the Museum before or after each meeting. See page 11 for more information about this and upcoming club meetings. This program is free and open to the public.

Saturdays beginning May 14 through October 29

Museum opens at 8:30 a.m. to all visitors. Tour the Museum's latest exhibits and shop at Farmer's Market.

Monday, May 30, 2011

Museum closed for Memorial Day Holiday



## MYSTERY HISTORY QUIZ

This issue's mystery photograph shows German picnickers gathered at a wooded grove in Bloomington, which was once a popular gathering place for this ethnic group (as well as others). Can you tell us where this grove is located and what's there today? If you think you know the answer, contact Librarian / Archivist Bill Kemp at [library@mchistory.org](mailto:library@mchistory.org) or (309) 827-0428.

## Mystery History

Last issue's photograph mystified quite a few of our regular history sleuths. Only two Museum members correctly identified the scene as downtown Saybrook during the community's centennial celebration of 1925. Although McLean County wasn't organized until Christmas Day 1830, and Saybrook wasn't officially platted until 1856, the village dates its origin to 1825 and the arrival of settler Jonathan Cheney.

Michael R. Tuttle wrote the Museum to say that his great-grandfather William C. Tuttle (1878-1951) attended the centennial celebration. "My grandfather Rex Tuttle was living in Chicago at the time [and he] received the newspaper clipping from the day's activities from his mother's parents, Cyrus and Adellma Zimmerman," Michael writes. "I still have the clipping with the regrets that he couldn't be there." In an email, Andy Streenz tells us that his father recognized the photo as the 1925 Saybrook centennial. "He wasn't around for that one," Andy says, "but he remembers vividly their sesquicentennial in 1975."



ADDRESS SERVICE REQUESTED

ADDRESS SERVICE REQUESTED



Non-Profit Organization  
U.S. Postage  
PAID  
Bloomington IL 61701  
PERMIT NO. 118